

MODEL DL-50b DIAGRAM PRIMARY CABINET DIMENSIONS

SPECIFICATIONS (CENTIMETERS ARE REPRESENTED BY [])

MAX TV SIZE : 65"
 MAX WEIGHT CAPACITY : 200 LBS [90.7 KG]
 MAX TRAVEL (EXTENSION) : 39.25" [99.7]
 LIFT SYSTEM HEIGHT : 28.5" [72.4] TO 40.5" [102.9]
 MAX TV HEIGHT : 38.5" [97.8] MINUS LID THICKNESS

QUICK REFERENCE DIMENSION GUIDE (USE WHICHEVER IS GREATER)

TV DIMENSIONS : W____, H____, D____
 MIN. INTERIOR CABINET WIDTH : $W+2"$ [5.1] = ____ OR 43.75" [111.1]
 MIN. LID CUTOUT WIDTH : $W+2"$ [5.1] = ____ OR 43.75" [111.1]
 MIN. INTERIOR CABINET HEIGHT : $H+1.5"$ [3.8] = ____ OR 29.5" [74.9]
 MIN. INTERIOR CABINET DEPTH : $(2 \times D)+7.375"$ [18.7] = ____
 MIN. LID CUTOUT DEPTH : $(2 \times D)+7.375"$ [18.7] = ____

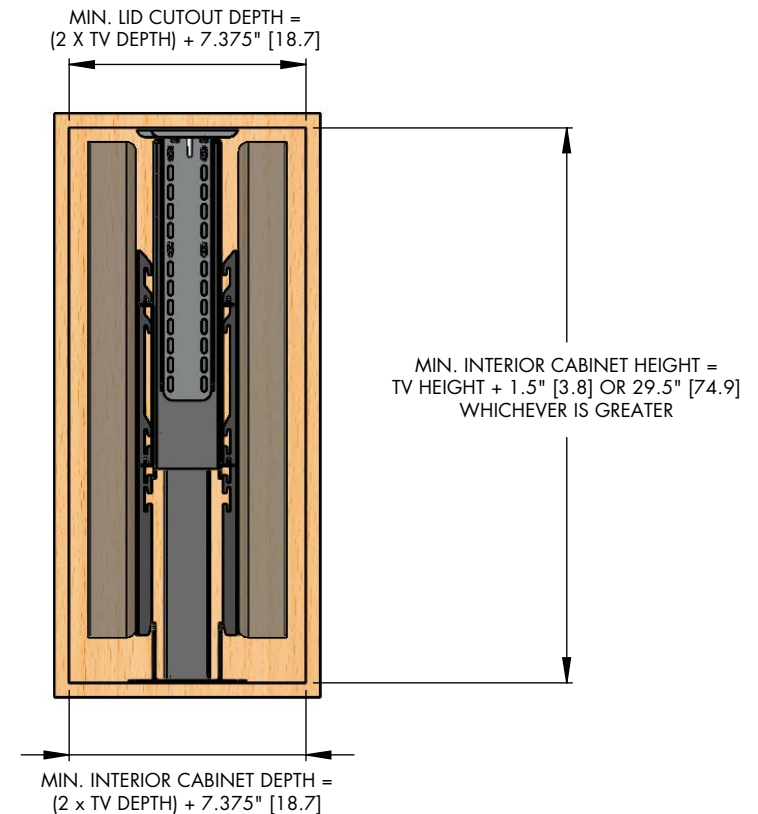
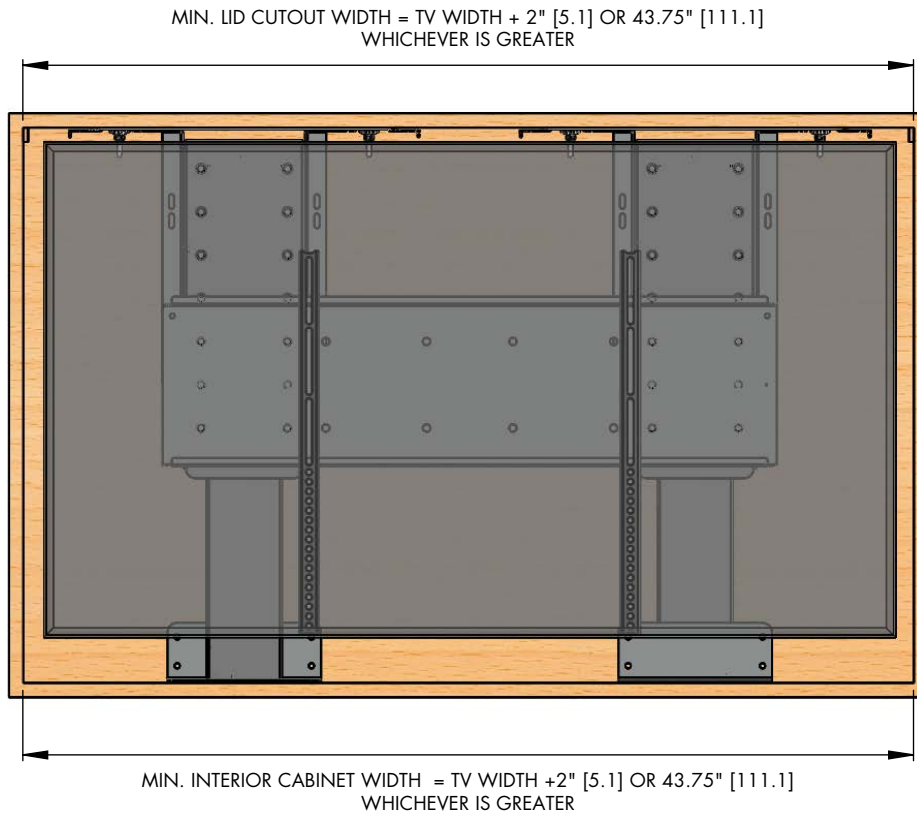

NOTES:

1. THE CABINET BOX SHOWN IN THE DIAGRAM IS FOR REFERENCE ONLY AND IS NOT PROVIDED WITH THE LIFT SYSTEM
2. WHEN DETERMINING TV HEIGHT, ALWAYS USE MANUFACTURER SUPPLIED "TV WITHOUT STAND" HEIGHT
3. LIFT MECHANISM IS POWDERCOATED BLACK STEEL, COLORS IN DIAGRAM ARE FOR CLARITY ONLY

NEXUS₂₁

COPYRIGHT 2019 - ALL RIGHTS RESERVED
 UPDATED 11/20/19

MODEL DL-50b DIAGRAM CABINET REFERENCE DIMENSIONS

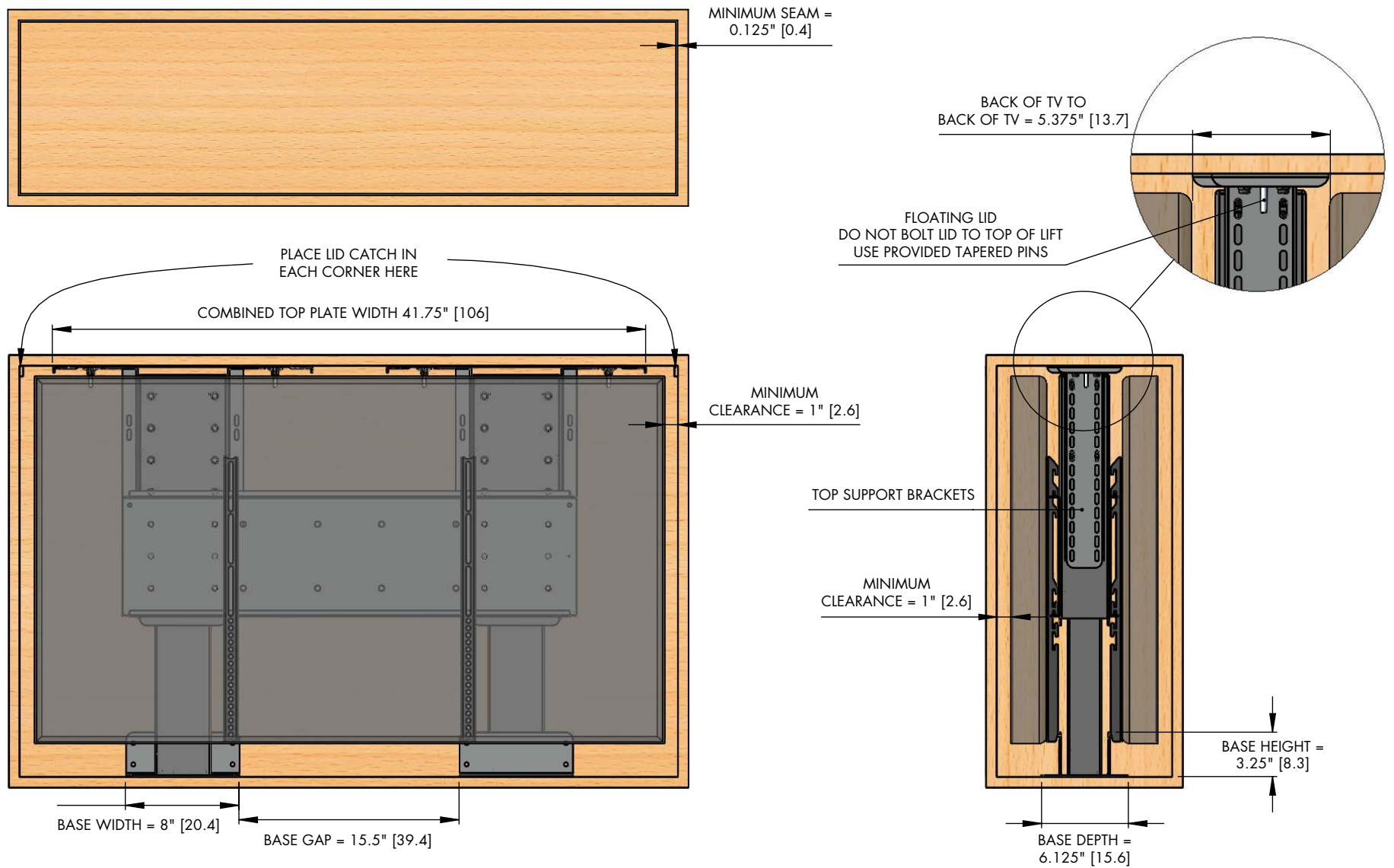

- NOTES:
1. TOP SUPPORT BRACKETS ALLOW TOP PLATE TO BE ADJUSTED FLUSH WITH UNDERSIDE OF LID
 2. TAPERED PINS ALLOW LID TO FLOAT WITH THE USE OF THE LID CATCHES.
 3. MINIMUM SEAM CAN BE REDUCED TO 0.0625" [0.2] WITH A 45 DEGREE BEVEL ON THE LID

NEXUS₂₁

COPYRIGHT 2019 - ALL RIGHTS RESERVED
UPDATED 11/20/19