

# MODEL L-27s DIAGRAM PRIMARY CABINET DIMENSIONS

## SPECIFICATIONS (CENTIMETERS ARE REPRESENTED BY [ ])

MAX TV SIZE : 48"  
 MAX WEIGHT CAPACITY : 130 LBS [59 KG]  
 MAX TRAVEL (EXTENSION) : 26.5" [67.3]  
 LIFT SYSTEM HEIGHT : 24.25" [61.6] TO 36.25" [92.1]  
 MAX TV HEIGHT : 25.5" [64.8] MINUS LID THICKNESS  
 MANUAL SWIVEL RANGE : +/- 180°

## QUICK REFERENCE DIMENSION GUIDE (USE WHICHEVER IS GREATER)

TV DIMENSIONS : W \_\_\_\_\_, H \_\_\_\_\_, D \_\_\_\_\_  
 MIN. INTERIOR CABINET WIDTH :  $W + 2" [5.1] = \text{_____} \text{ OR } 26" [66]$   
 MIN. LID CUTOUT WIDTH :  $W + 2" [5.1] = \text{_____} \text{ OR } 26" [66]$   
 MIN. INTERIOR CABINET HEIGHT :  $H + 1" [2.6] = \text{_____} \text{ OR } 24.25" [61.6]$   
 MIN. INTERIOR CABINET DEPTH :  $D + 6" [15.2] = \text{_____}$   
 MIN. LID CUTOUT DEPTH :  $D + 6" [15.2] = \text{_____}$

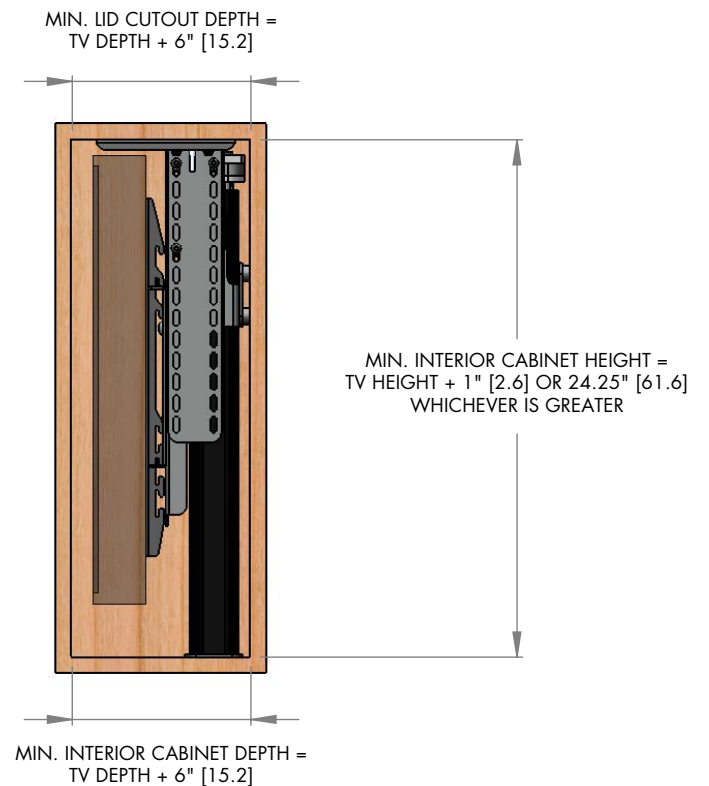
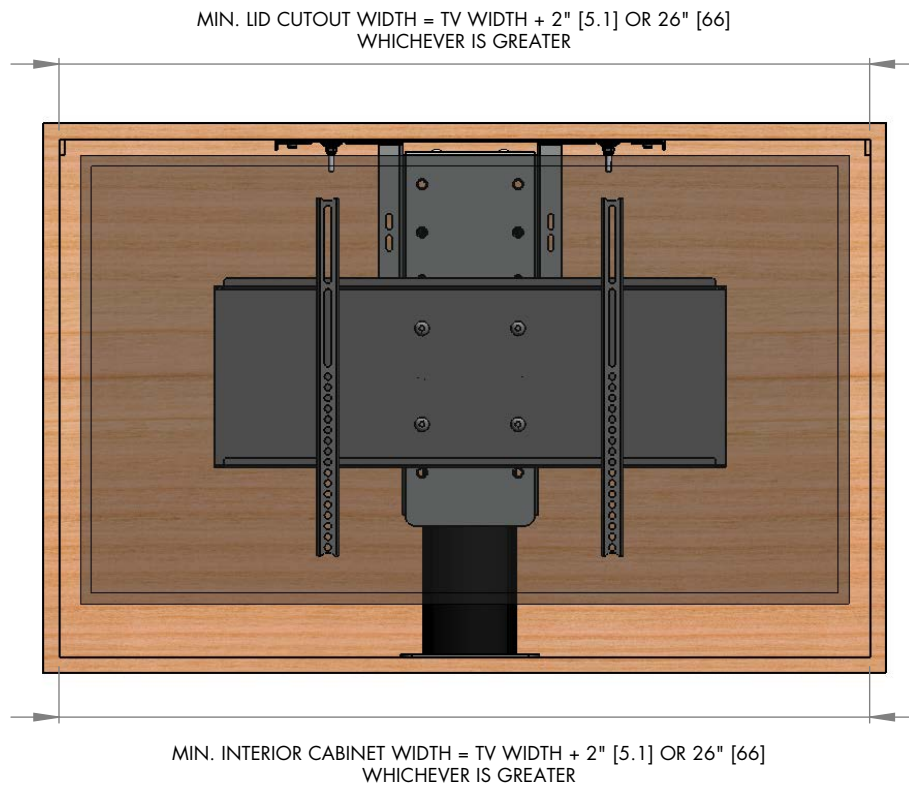

- NOTES:
1. THE CABINET BOX SHOWN IN THE DIAGRAM IS FOR REFERENCE ONLY AND IS NOT PROVIDED WITH THE LIFT SYSTEM
  2. WHEN DETERMINING TV HEIGHT, ALWAYS USE MANUFACTURER SUPPLIED "TV WITHOUT STAND" HEIGHT
  3. LIFT MECHANISM IS POWDERCOATED BLACK STEEL, COLORS IN DIAGRAM ARE FOR CLARITY ONLY

# MODEL L-27s DIAGRAM CABINET REFERENCE DIMENSIONS

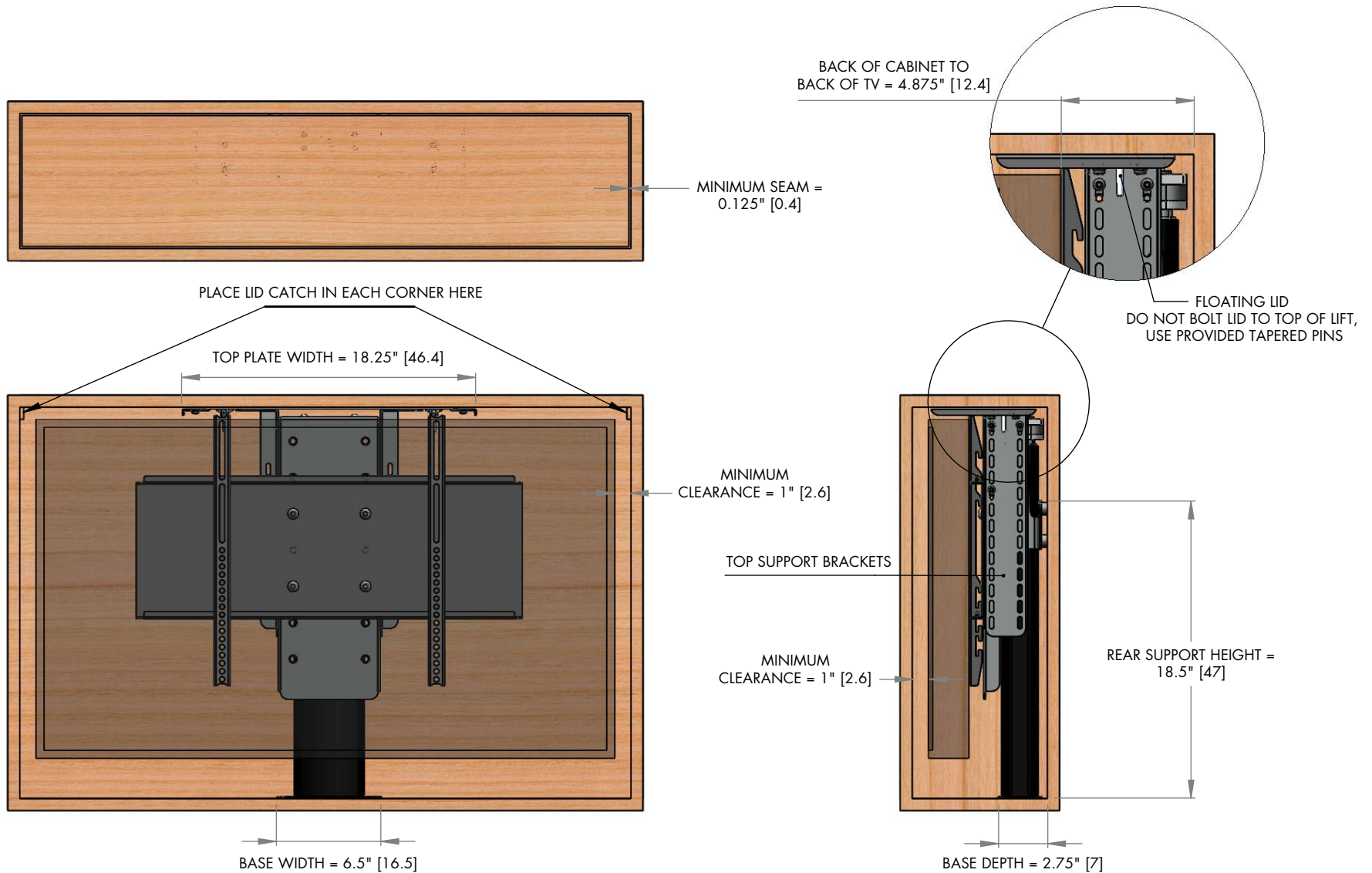

**NOTES:**

1. TOP SUPPORT BRACKETS ALLOW TOP PLATE TO BE ADJUSTED FLUSH WITH UNDERSIDE OF LID
2. TAPERED PINS ALLOW LID TO FLOAT WITH THE USE OF THE LID CATCHES.
3. MINIMUM SEAM CAN BE REDUCED TO 0.0625" [0.2] WITH A 45 DEGREE BEVEL ON THE LID

**NEXUS<sub>21</sub>**

COPYRIGHT 2019 - ALL RIGHTS RESERVED  
 UPDATED 11/15/19